

## Technical Data Sheet

# wave - i

### Voltage Stabilizer 145-285V

The wave is an efficient small size voltage stabilizer system designed for OEM installation. It has been designed for applications such as

- Glass Door coolers
- Chest Freezers



Its advanced design and control features are managed by the advanced microcontroller technology and patented algorithms.

### Features

<ul style="list-style-type: none"> <li>• <b>wave</b> is a Voltage and Frequency Supervisor</li> <li>• If voltage goes out of range <b>wave</b> will automatically disconnect the device</li> <li>• Condenser area monitoring for thermal event prevention</li> <li>• <b>wave</b> will boost or reduce the voltage output to keep it running within its voltage tolerances</li> </ul>	<ul style="list-style-type: none"> <li>• <b>wave</b> constantly monitors the supply to the connected appliance and decides when it must</li> <li>• Smart 3 Minute delay to protect from unstable supply</li> <li>• Surge protection to protect against voltage spikes</li> <li>• Zero Voltage Switching to achieve smooth output</li> </ul>
--	---

### Technical Data

Product	Measure	wave-i 045	wave-i 070	wave-i 090	wave-i 120
Power Supply	Operational Bandwidth	90 - 310 VAC			
Input	Max Low Voltage	145V ± 3% with hysteresis			
	Min High Voltage	285V ± 3% with hysteresis			
Output	HBP/MBP Application	196 – 245 VAC ±3%			
Output Current	Maximum	2.0A	3.0A	4.0A	5.0A
	Continuous Operation	1.5A	2.2A	3.0A	4.5A
Frequency Supervisor	Lower Limit (50/60 Hz)	47 Hz/ 57 Hz (±0.2Hz)			
	Upper Limit (50/60 Hz)	53 Hz/ 63 Hz (±0.2Hz)			

Thermal protection	DT increase cut-out	15°C per 15 minutes
Environmental	Ambient Temperature	-40 to 65 °C
	Humidity	85 %RH
Life time	Relay lifetime Cycles	100,000
Plastic Housing		UL94 V-0 Flame Retardant
Insulation class	Transformer Windings	F ( 155 °C)
Start Up Time	Time Delay	3 minutes ( 2'30" +0 to 30" random) zero on Production Line

Input Vs Output Graph 145V-285V (No Load)

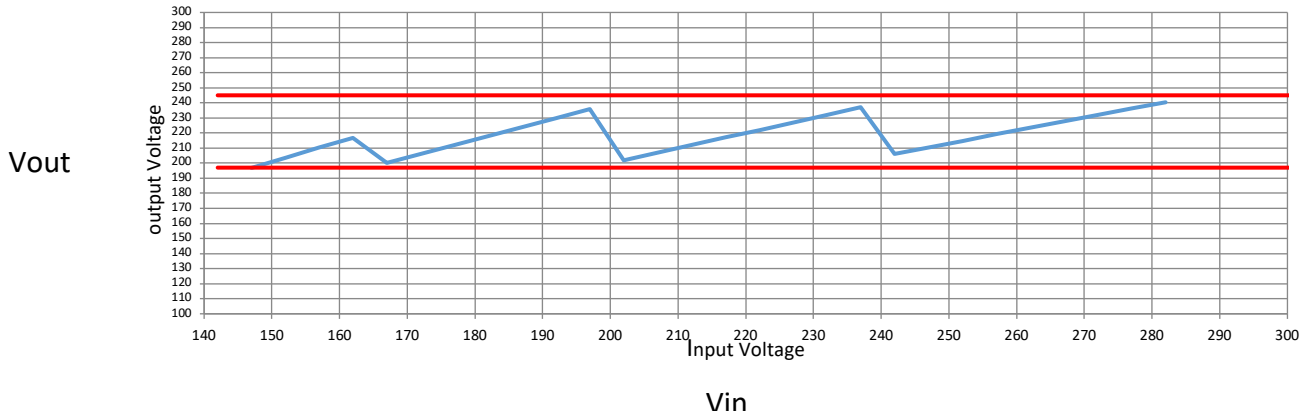

Dimensions and Weights

	045	070	090	120
A	105	110	110	120
B	75	75	86	86
C	84	84	96	96
D	50	55	55	55
E	73	73	82	82
Weight (KG)	1.8	2.02	3.66	3.23

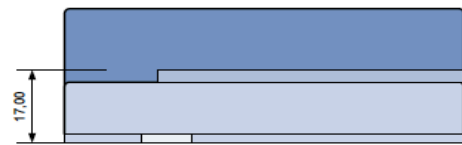
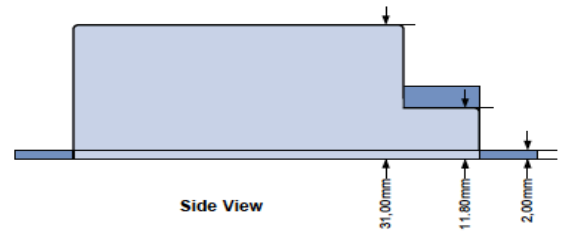
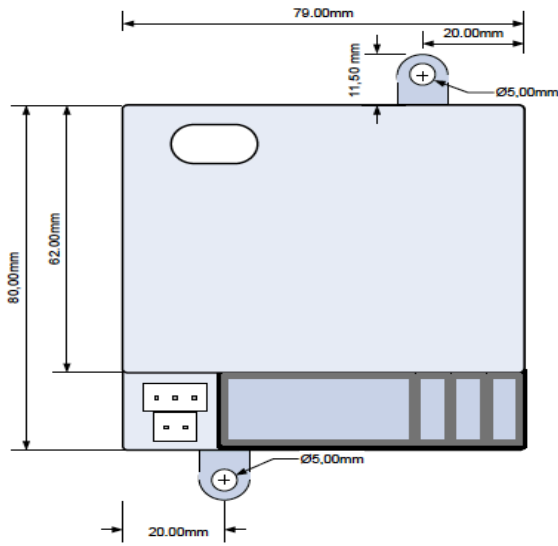
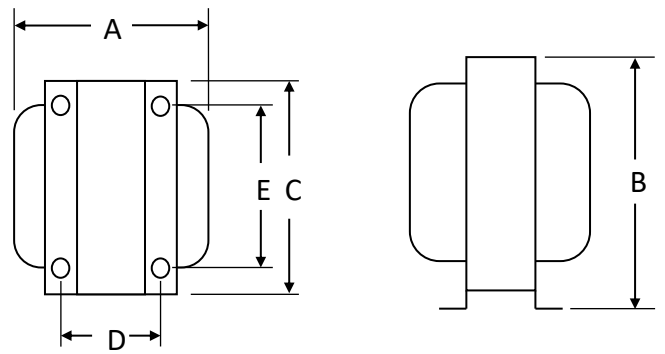

Top View

Side View

Front View

Approvals	
CE	LVD European Directive 2014/35/EU • EN 61558-1:2005 +A1:2009 • EN 61558-2-13:2009 • EN 60730-1:2016 • EN 60730-2-9:2010 Type of automatic action of Control: type 2 action
	EMC European Directive 2014/30/EU • EN 61000-6-1:2007 • EN 61000-6-3:2007+A1:2011 • EN 60730-1:2016 • EN 60730-2-9:2010 • EN 62041:2010 EMC testing under nominal values of current and voltage